

# ZVOLTZ

## Galaxy S6 Battery Case

### User's Manual

## WHAT'S IN THE BOX

### ZVOLTZ Battery Case

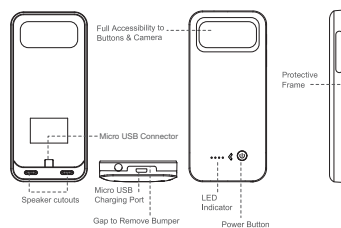

### Micro USB Charging Cable



### User's Manual



## INSTALLATION

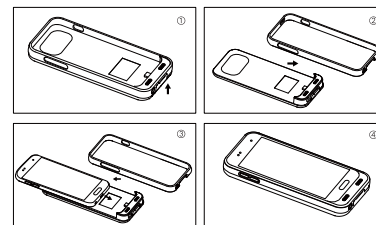

1. Lift the bumper from the gap located on the bottom of the case.
2. Gently separate the bumper from the case.
3. Slide the Galaxy onto the battery case. Make sure to snugly connect the phone to the Micro USB connector.
4. Snap the bumper onto the back case and make sure there are no gaps between the bumper and back casing.
5. To uninstall the case, simply reverse the steps of 1-4.

### How to charge the Galaxy S6

1. Place the Galaxy S6 into the ZVOLTZ case.
2. Press and hold the power button for 2 seconds, **the case will begin to charge.**
3. When charging starts, the Galaxy will vibrate or give a beep sound.
4. The battery icon on the upper right corner of the screen will feature a lightning bolt to indicate that charging is in progress.

## HOW TO CHARGE

### How to charge the ZVOLTZ Battery Case

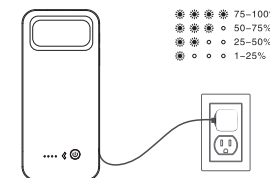

1. Connect the case to any USB charging port via the provided USB cable, and the case will start charging. The LED indicator will flash when charging, and it will become steady when fully charged.
2. If you are going to charge the case and Galaxy together, make sure to install the case on the Galaxy before connecting them to a power source. The external power source will fully charge the Galaxy first, then recharge the case.

### Quick Charge Capable

The battery case will work with Qualcomm Quick Charge 2.0, however it will require the use of a Quick Charge 2.0 charger. The battery case by itself will only charge the phone at 5V/2.1A max.

## CHARGING & CONTROLS

### LED Indicator

Press and hold the power button to turn the case ON. Once powered ON the LED indicator located on the back of the case will display remaining power levels. To check remaining power levels while the case is equipped, simply press the button and the LED indicator will show current power levels. The LED Indicator will automatically shut off after 10 seconds. Power levels and their corresponding % are shown below.



### Synchronization

The battery case supports sync-through technology. This means that you can sync your Galaxy to a computer without having to take the battery case off. Simply plug the microUSB cable into the phone and the other end into the computer's USB slot. Synchronization will begin immediately.

Need Help?  
Contact us at [zvoltz2014@gmail.com](mailto:zvoltz2014@gmail.com)

## CHARGING & CONTROLS

### Specifications

Zvoltz Battery Case	
Battery type:	Li-Polymer
Capacity:	3500mAh
Micro Input:	5V/2.1A + Quick-charge 2.0
Micro output:	5V/2.1A + Quick-charge 2.0
Dimension:	2.9in x 6.1in x 0.55in
Weight:	Approx. 3.2oz
Input interface:	MicroUSB
Charging time:	Approx 5-6 hrs via 5V/2.1A
Charging time:	Approx 3-4 hrs via Quick-charge
Charging cable:	Micro USB

### FAQs

Question	Answer
The Galaxy & battery case do not charge together	Charge the battery case alone for one hour, then resume charging both the case and the phone together.
The case does not charge the phone	Check to see if the connection is secure. Make sure the battery case has power.
Does this battery case support Quick Charge 2.0?	Yes, the battery case supports Quick Charge for Samsung. For more details, see Quick-charge capable section.

## BENEFITS & WARNINGS

### Additional Hours

- Add 25 hours talk time
- Add 13 hours web browsing time
- Add 63 hours music playback time
- Add 14 hours video playback time

### Warning

1. Product is covered by 1 year manufacturer warranty.
2. Please read all instructions and warnings prior to using this case.
3. Do not modify, disassemble, crush, open, or puncture the battery case.
4. Do not expose the product to water, rain, or any chemical liquid.
5. Keep the product from direct sunlight and open flame to prevent overheating.
6. This product is not a toy, please keep the product away from children.

# ZVOLTZ

## Galaxy S6 Battery Case

1-Year Limited Warranty  
[zvoltz2014@gmail.com](mailto:zvoltz2014@gmail.com)  
[www.zvoltz.com](http://www.zvoltz.com)