

ZVOLTZ

iPhone 6 Plus & 6s Plus Battery Case

User's Manual

WHAT'S IN THE BOX

ZVOLTZ Battery Case

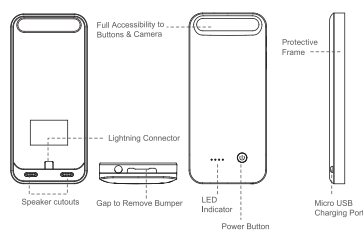

Micro USB Charging Cable



Headphone Jack Extender

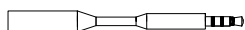

Screen Protector



INSTALLATION

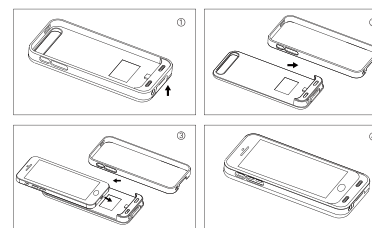

1. Lift the bumper from the gap located on the bottom of the case.
2. Gently separate the bumper from the case.
3. Slide the iPhone onto the battery case. Make sure to snugly connect the phone to the lightning connector.
4. Snap the bumper onto the back case and make sure there are no gaps between the bumper and back casing.
5. To uninstall the case, simply reverse the steps of 1-4.

HOW TO CHARGE

How to charge the ZVOLTZ Battery Case

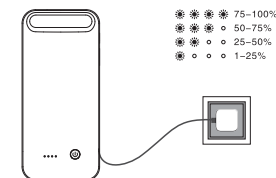

1. Connect the case to any USB charging port via the provided USB cable, and the case will start charging. The LED indicator will flash when charging, and it will become steady when fully charged.
2. If you are going to charge the case and iPhone together, make sure to install the case on the iPhone before connecting them to a power source. The external power source will fully charge the iPhone first, then recharge the case.

How to charge the iPhone 6

1. Place the iPhone into the ZVOLTZ case.
2. Press and hold the power switch button for 2 seconds, the case will begin to charge.
3. When charging starts, the iPhone will vibrate or give a beep sound.
4. The battery icon on the upper right corner of the screen will feature a lightning bolt to indicate that charging is in progress.

CHARGING & CONTROLS

Press the button once, the LEDs will light up to show the remaining power in the case as following.



Power is switched off by default. Right after installation of the case press and hold the button for 2 seconds to manually turn the charger ON or OFF.



Synchronization

The battery case supports sync-through technology. This means that you can sync your iPhone to a computer without having to take the battery case off. Simply plug the microUSB cable into the phone and the other end into the computer's USB slot. Synchronization will begin immediately.

CHARGING & CONTROLS

Specifications

| | |
|---------------|----------------------|
| Battery type: | Li-polymer |
| Capacity: | 3.7V/4000mAh |
| Input: | DC 5V/1A (Max) |
| Output: | DC 5V±0.25V/1A |
| Dimension: | 172.7*81.5*19.0 (mm) |

FAQs

| FAQs | FAQs |
|--|--|
| The iPhone & battery case do not charge together | Charge the battery case alone for one hour, then resume charging both the case and the phone together. |
| The case does not charge the phone | Check to see if the connection is secure. Make sure the case battery has power. |
| The phone cannot be synced thru the case | Please check if the USB Cable is connected securely. Try different computers to check software compatibility of itunes. |
| Phone shows "does not support charge" | Typically caused by aftermarket wall chargers or unstable laptop USB outputs. Try using the original apple wall charger to charge. |

BENEFITS & WARNINGS

Additional Hours

- Add 29 hours talk time on 3G
- Add 14 hours web browsing time
- Add 96 hours music playback time
- Add 17 hours video playback time

Warning

1. Product is covered by 1 year manufacturer warranty.
2. Please read all instructions and warnings prior to using this case.
3. Do not modify, disassemble, crush, open, or puncture the battery case.
4. Do not expose the product to water, rain, or any chemical liquid.
5. Keep the product from direct sunlight and open flame to prevent overheating.
6. This product is not a toy, please keep the product away from children.

ZVOLTZ

iPhone 6 Plus & 6s Plus Battery Case

1-Year Limited Warranty

service@zvoltz.com
www.zvoltz.com





